

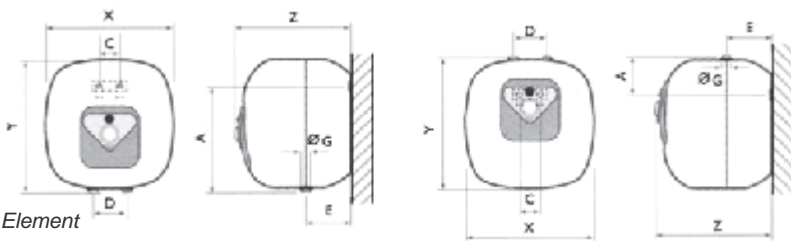

Stainless Steel Heating Element



INDEPENDENT INSTALLATION

EV water heaters are ideal for obtaining hot water in places not connected to a centralised system. All you need is a cold water supply and an electrical socket to easily install the appliance. This appliance is particularly suitable for small apartments, utility rooms, the work-place, camper vans etc. EV models are available in 10, 15 and 30 litre sizes and so when installed independently allow 2 simultaneous usages (about 30 litres). EV can also be used as part of an open outlet tap group.

INSTALLATION IN-LINE AS PART OF A SYSTEM

EV models can be installed as part of a medium sized or large centralised system, in this case water can be heated to the maximum temperature, e.g. 60 °C, only at the point of use and the main reserve of hot water can be kept at a medium temperature, e.g. 40°C. With this kind of system you get the best quality of service with a high level of energy saving.

The number of simultaneous usages is strictly related to the number of appliances installed and the size of the central water heater.

	X	Y	Z	A	C	D	E	CAPACITY	KW	VOLTAGE	HEATING TIME	WORKING PRESSURE	STEEL THICKNESS OF TANK	INSULATION THICKNESS	IP	WEIGHT
								litres	W	V	Δt-65°C	MPa	mm (average)	mm (average)	PI	kg
SOPRA LAVELLO - ABOVE SINK																
E10SP	340	350	290	259	66	100	85	1/2"	10	1500	220-240	25'	0,8	18/10	28	7,5
E15SP	375	388	345	278	66	100	85	1/2"	15	1500	220-240	35'	0,8	18/10	28	8,5
E30SP	453	466	412	336	66	100	115	1/2"	30	1500	220-240	1 h, 10'	0,8	18/10	28	12,0
SOTTO LAVELLO - UNDER SINK																
E10ST	340	350	290	96	66	100	85	1/2"	10	1500	220-240	25'	0,8	18/10	28	7,5
E15ST	375	388	345	115	66	100	85	1/2"	15	1500	220-240	35'	0,8	18/10	28	8,5

The right amount of hot water just where you need it.

WaterHeater
Sales

Chasewood Business Park
Heath Hayes
Staffordshire
WS12 3XR

Tel: 01543 276019

Web: www.waterheatersales.co.uk
Email: sales@waterheatersales.co.uk

